

Pipe Tee Dimensions Standard Reducing & Equal Tee

Pipe Tee dimensions are covered in ASME B16.9. Refer to the table given below for the size 1/2" to 48". In piping, two types of tees are used, straight or equal and reducing tee. The following shall be checked during the inspection of Pipe Tee Dimensions.

- The diameter of the branch and run pipe
- The thickness of the tee
- Center to center dimension for branch
- Length of the tee.

Straight / Equal Tee Dimensions

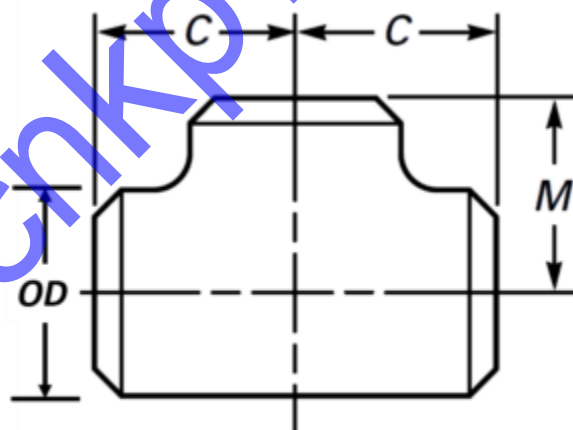

Equal Tee

Pipe Tee Dimensions As Per ASME B16.9

NOMINAL PIPE SIZE	OUTSIDE DIAMETER	CENTER TO END	LENGTH
Inch.	OD	C	M
1/2	21.3	25	25
3/4	26.7	29	29
1	33.4	38	38
1 1/4	42.2	48	48
1 1/2	48.3	57	57
2	60.3	64	64
2 1/2	73	76	76
3	88.9	86	86
3 1/2	101.6	95	95
4	114.3	105	105
5	141.3	124	124
6	168.3	143	143
8	219.1	178	178
10	273.1	216	216
12	323.9	254	254
14	355.6	279	279
16	406.4	305	305
18	457.2	343	343
20	508	381	381

Pipe Tee Dimensions As Per ASME B16.9			
NOMINAL PIPE SIZE	OUTSIDE DIAMETER	CENTER TO END	LENGTH
22	559	419	419
24	610	432	432
26	660	495	495
28	711	521	521
30	762	559	559
32	813	597	597
34	864	635	635
36	914	673	673
38	965	711	711
40	1016	749	749
42	1067	762	711
44	1118	813	762
46	1168	851	800
48	1219	889	838
All Dimensions are in mm			

Reducing Tee Dimensions

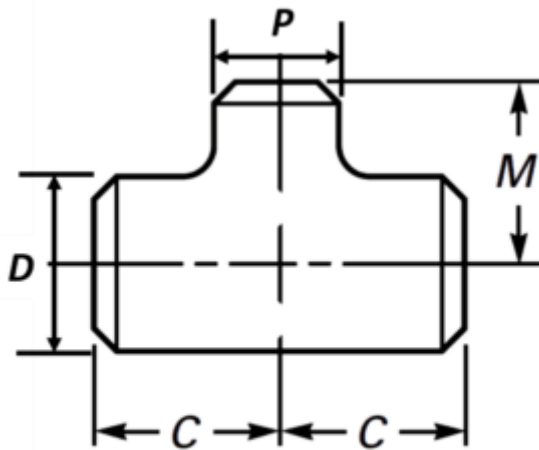

Unequal Tee

Pipe Tee Dimensions As Per ASME B16.9				
NOMINAL PIPE SIZE	OUTSIDE DIAMETER		CENTER TO END	
Inch	D	P	C	M
1/2 x 3/8	21.3	17.1	25	25
1/2 x 1/4	21.3	13.7	25	25
3/4 x 1/2	26.7	21.3	29	29
3/4 x 3/8	26.7	17.1	29	29
1 x 3/4	33.4	26.7	38	38
1 x 1/2	33.4	21.3	38	38
1 1/4 x 1	42.2	33.4	48	48
1 1/4 x 3/4	42.2	26.7	48	48
1 1/4 x 1/2	42.2	21.3	48	48
1 1/2 x 1 1/2	48.3	42.2	57	57
1 1/2 x 1	48.3	33.4	57	57

Pipe Tee Dimensions As Per ASME B16.9

NOMINAL PIPE SIZE	OUTSIDE DIAMETER		CENTER TO END	
1 1/2 x 3/4	48.3	26.7	57	57
1 1/2 x 1/2	48.3	21.3	57	57
2 x 1 1/2	60.3	48.2	64	60
2 x 1 1/4	60.3	42.2	64	57
2 x 1	60.3	33.4	64	51
2 x 3/4	60.3	26.7	64	44
2 1/2 x 2	73	60.3	76	70
2 1/2 x 1 1/2	73	48.3	76	67
2 1/2 x 1 1/4	73	42.2	76	64
2 1/2 x 1	73	33.4	76	57
3 x 2 1/2	88.9	73	86	83
3 x 2	88.9	60.3	86	76
3 x 1 1/2	88.9	48.3	86	73
3 x 1 1/4	88.9	42.2	86	70
3 1/2 x 3	101.6	88.9	95	92
3 1/2 x 2 1/2	101.6	73	95	89
3 1/2 x 2	101.6	60.3	95	83
3 1/2 x 1 1/2	101.6	48.3	95	79
4 x 3 1/2	114.3	101.6	105	102
4 x 3	114.3	88.9	105	98

Pipe Tee Dimensions As Per ASME B16.9

NOMINAL PIPE SIZE	OUTSIDE DIAMETER		CENTER TO END	
4 x 2 1/2	114.3	73	105	95
4 x 2	114.3	60.3	105	89
4 x 1 1/2	114.3	48.3	105	86
5 x 4	141.3	114.3	124	117
5 x 3 1/2	141.3	101.6	124	114
5 x 3	141.3	88.9	124	111
5 x 2 1/2	141.3	73	124	108
5 x 2	141.3	60.3	124	105
6 x 5	168.3	141.3	143	137
6 x 4	168.3	114.3	143	130
6 x 3 1/2	168.3	101.6	143	127
6 x 3	168.3	88.9	143	124
6 x 2 1/2	168.3	73	143	121
8 x 6	219.1	168.3	178	168
8 x 5	219.1	141.3	178	162
8 x 4	219.1	114.3	178	156
8 x 3 1/2	219.1	101.6	178	152
10 x 8	273.1	219.1	216	203
10 x 6	273.1	168.1	216	194
10 x 5	273.1	141.3	216	191

Pipe Tee Dimensions As Per ASME B16.9

NOMINAL PIPE SIZE	OUTSIDE DIAMETER		CENTER TO END	
10 x 4	273.1	114.3	216	184
12 x 10	323.9	273.1	254	241
12 x 8	323.9	219.1	254	229
12 x 6	323.9	168.3	254	219
12 x 5	323.9	141.3	254	216
14 x 12	355.6	323.9	279	270
14 x 10	355.6	273.1	279	257
14 x 8	355.6	219.1	279	248
14 x 6	355.6	168.3	279	238
16 x 14	406.4	355.6	305	305
16 x 12	406.4	323.9	305	295
16 x 10	406.4	273.1	305	283
16 x 8	406.4	219.1	305	273
16 x 6	406.4	168.3	305	264
18 x 16	457	406.4	343	330
18 x 14	457	355.6	343	330
18 x 12	457	323.9	343	321
18 x 10	457	273.1	343	308
18 x 8	457	219.1	343	298
20 x 18	508	457	381	368

Pipe Tee Dimensions As Per ASME B16.9

NOMINAL PIPE SIZE	OUTSIDE DIAMETER		CENTER TO END	
20 x 16	508	406.4	381	356
20 x 14	508	355.6	381	356
20 x 12	508	323.9	381	346
20 x 10	508	273.1	381	333
20 x 8	508	219.1	381	324
22 x 20	559	508	419	406
22 x 18	559	457	419	394
22 x 16	559	406.4	419	381
22 x 14	559	355.6	419	381
22 x 12	559	323.9	419	371
24 x 10	559	273.1	419	359
24 x 22	610	559	432	432
24 x 20	610	508	432	432
24 x 18	610	457	432	419
24 x 16	610	406.4	432	406
24 x 14	610	355.6	432	406
24 x 12	610	323.9	432	397
24 x 10	610	273.1	432	384
All Dimensions are in mm				

Pipe Fittings Dimensions Tolerance as per ASME B16.9

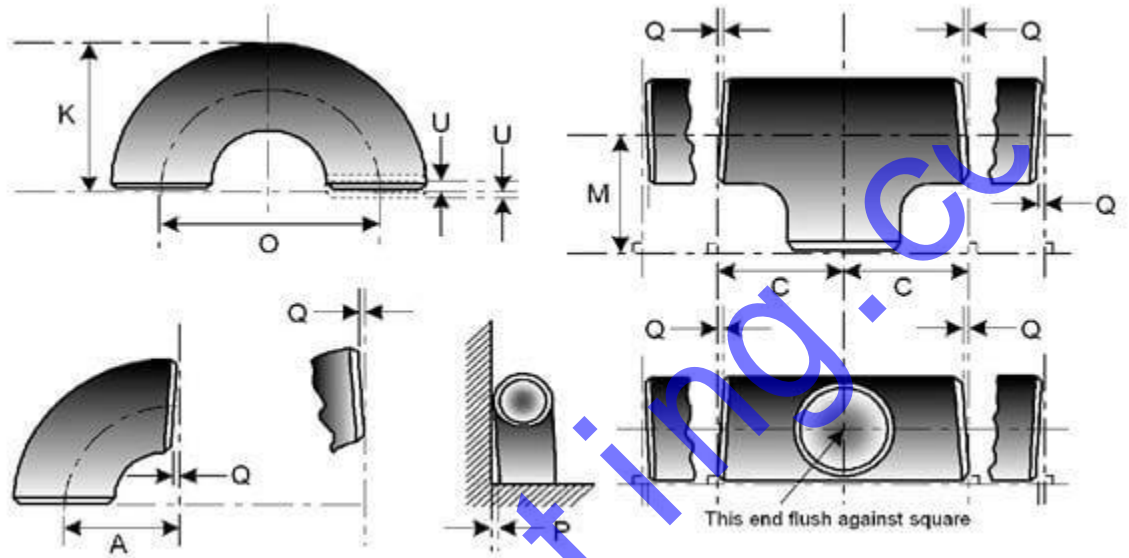

ankpipefitting.com

NOMINAL PIPE SIZE	ALL FITTINGS	ALL FITTINGS	ALL FITTINGS	ELBOWS AND TEES	180 DEG RETURN BENDS	180 DEG RETURN BENDS	180 DEG RETURN BENDS	REDUCERS	CAPS
NPS	O.D. at Bevel (1), (2)	I.D. at End (1), (3), (4)	Wall Thickness (3)	Centre-to-End Dimension A, B, C, M	Centre-to-Centre O	Back-to-Face K	Alignm ent of Ends U	Overall Length H	Overall Length E
½ to 2½	0.06 -0.03	0.03	Not less than 87.5% of nominal thickness	0.06	0.25	0.25	0.03	0.06	0.12
3 to 3 ½	0.06	0.06		0.06	0.25	0.25	0.03	0.06	0.12
4	0.06	0.06		0.06	0.25	0.25	0.03	0.06	0.12
5 to 8	0.09 -0.06	0.06		0.06	0.25	0.25	0.03	0.06	0.25
10 to 18	0.16 -0.12	0.12		0.09	0.38	0.25	0.06	0.09	0.25
20 to 24	0.25 -0.19	0.19		0.09	0.38	0.25	0.06	0.09	0.25
26 to 30	0.25 -0.19	0.19		0.12	0.19	0.38
32 to 48	0.25 -0.19	0.19		0.19	0.19	0.38

NOMINAL PIPE SIZE NPS	ANGULARITY TOLERANCES	ANGULARITY TOLERANCES	ALL DIMENSIONS ARE GIVEN IN INCHES. TOLERANCES ARE EQUAL PLUS AND MINUS EXCEPT AS NOTED.
	Off Angle Q	Off Plane P	(1) Out-of-round is the sum of absolute values of plus and minus tolerance. (2) This tolerance may not apply in localized areas of formed fittings where increased wall thickness is required to meet design requirements of ASME B16.9. (3) The inside diameter and the nominal wall thicknesses at ends are to be specified by
½ to 4	0.03	0.06	
5 to 8	0.06	0.12	
10 to 12	0.09	0.19	

14 to 16	0.09	0.25	<p>the purchaser.</p> <p>(4) Unless otherwise specified by the purchaser, these tolerances apply to the nominal inside diameter, which equals the difference between the nominal outside diameter and twice the nominal wall thickness.</p>
18 to 24	0.12	0.38	
26 to 30	0.19	0.38	
32 to 42	0.19	0.50	
44 to 48	0.18	0.75	

ankpiperfitting.co